

Microamplifiers

WSS-100



The **WSS-100** split-band amplifier is designed for separate (built-in two gain potentiometers) amplifying signals in FM+VHF and UHF bands and distribute them into three outputs to several subscribers. Amplifier is powered via coaxial cable from output (OUT) or from external socket type mini Jack. Amplifier contains the jumper enables DC power pass for external TV preamplifier.

WSA-815, WSA-828, WSA-833

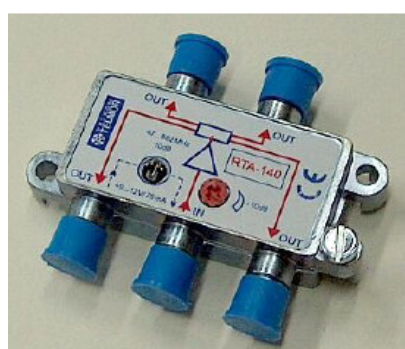

The **WSA-815**, **WSA-828** and **WSA-833** amplifier's are designed for broadband application – CATV. Micro-amplifiers series WSA exist in several versions:

- **WSA-815** and **WSA-828** with fixed gain
- **WSA-833** with adjustable gain

All micro-amplifiers are dedicated for indoor use.

- Designed for individual and collective application
- Gain regulation for FM+VHF and UHF signals separately
- Built-in ESD protection
- Low noise figure
- Local or remote powered
- DC power pass from OUT to IN
- Metal die-cast housing

TECHNICAL SPECIFICATIONS

Type of amplifier		WSA-815	WSA-828	WSA-833	WSS-100	
Frequency range	MHz	FM+VHF+UHF			FM+VHF	UHF
		47...862			47...230	470...862
Gain	dB	2 x 15	28	33 (± 2)	16	19
Gain regulation	dB	/	/	-14	-16	-16
Noise figure	dB	typ. 5,0	typ. 5,0	typ. 5,5	< 5	< 3
Max. input level	dBuV	91	79	/	100	86
Max. output level - for 2 TV channel	dBuV	2 x 106	107	122	108	99
Number of outputs	/	2	1	1	3	
Power supply / Current consumption	V/mA	+ 9 / 100	+ 9 / 150	+ 9...12 / 125 *	+12 / 60 *	
Input/output impedance	Ω	75				
Input/output connectors	/	F female				

* local or remote power supply

APPLICATIONS EXAMPLE

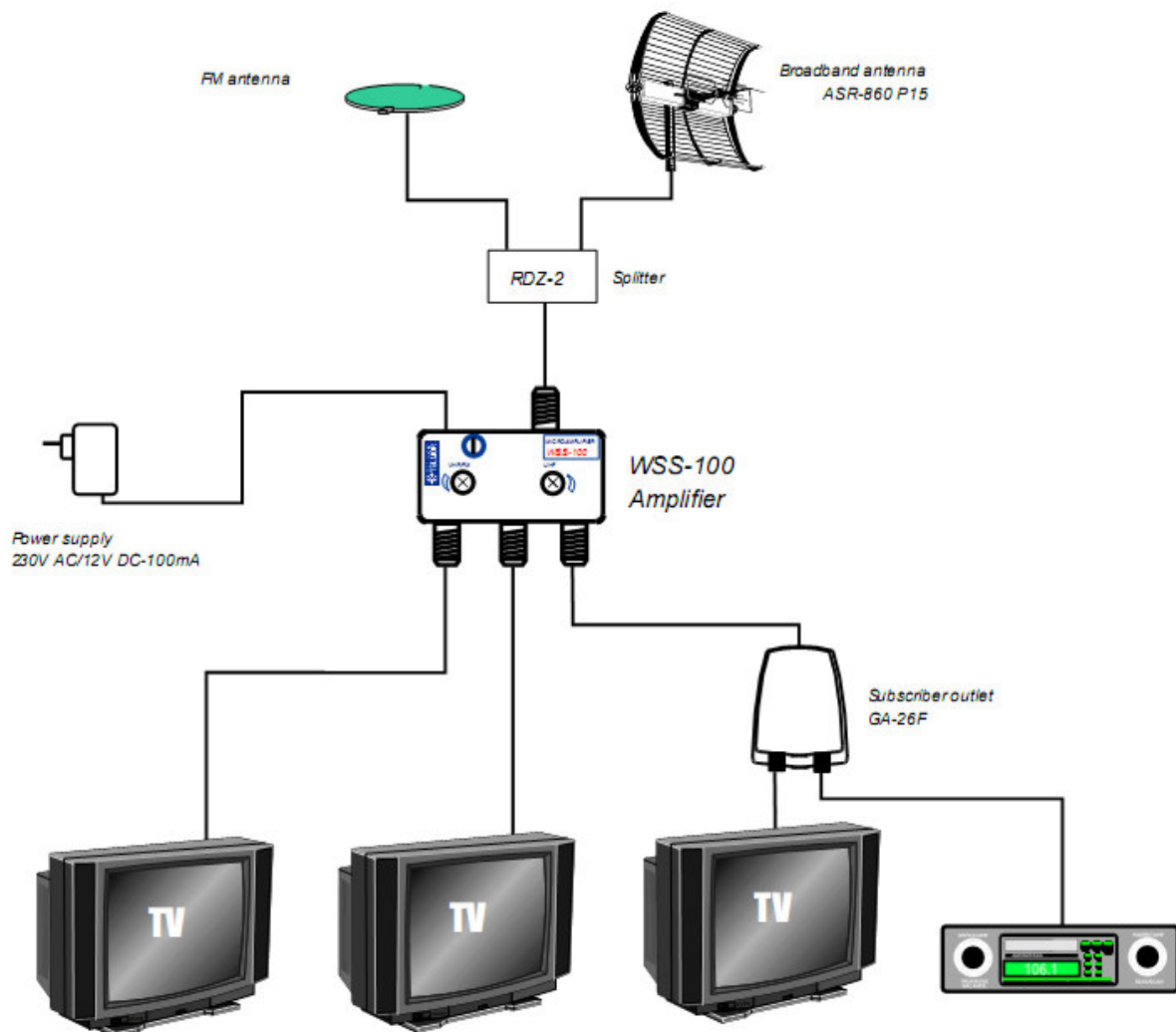

www.telmor.pl